



Approved by

Esmond Mo

Issued by

Leo Cui

CATALOGUE OF STAINLESS OUTDOOR CABINET

Document Id

SG-CO-2006-0001

Revision

REV 1

Date

2020-6-4

Page

1 (13)

Catalogue of Stainless Outdoor Cabinet

Si-GOU Technologies Co., Ltd.



Approved by
Esmond Mo

Issued by
Leo Cui

CATALOGUE OF STAINLESS OUTDOOR CABINET

Document Id
SG-CO-2006-0001

Date
2020-6-4

Revision
REV 1

Page
2 (13)

1. Contents

1. *Contents* 2

2. *Revision history* 3

3. *Introduction* 4

4. *Mounting panel type* 5

5. *19 inch mounting rails type* 8

6. *General type* 10

7. *Large type* 11

8. *Contact us* 13



Approved by

Esmond Mo

Issued by

Leo Cui

CATALOGUE OF STAINLESS OUTDOOR CABINET

Document Id

SG-CO-2006-0001

Revision

REV 1

Date

2020-6-4

Page

3 (13)

2. Revision history

1. Revision 0 First official release.
2. Revision 1 to update document with new Logo and company name on 11/11/2020.



Approved by

Esmond Mo

Issued by

Leo Cui

CATALOGUE OF STAINLESS OUTDOOR CABINET

Document Id

SG-CO-2006-0001

Revision

REV 1

Date

2020-6-4

Page

4 (13)

3. Introduction

Si-GOU Technologies Co., Ltd. specialized in develop and manufacture of telecommunication network infrastructure. Product covers Fiber optic connectivity product, ODN product (optical distribution network), structure cabling product, Copper connectivity product and Outdoor cabinet etc.

This document shows the Stainless Outdoor Cabinet. It is a brief outline of related products. Please contact us for more information.

4. Mounting panel type

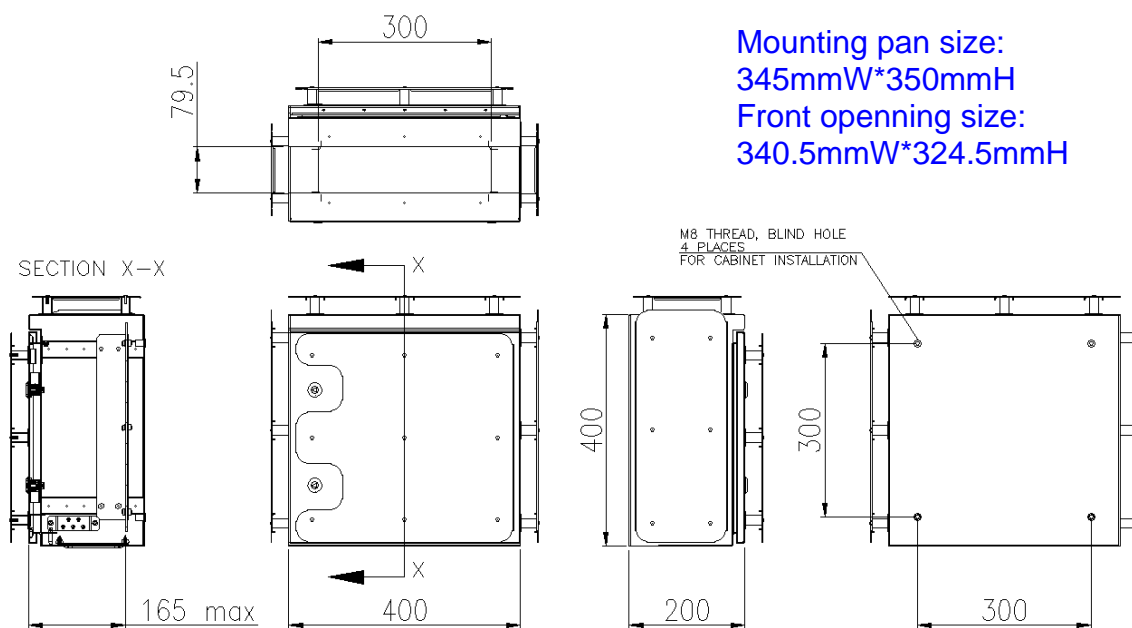

381700000: SGC-CA12

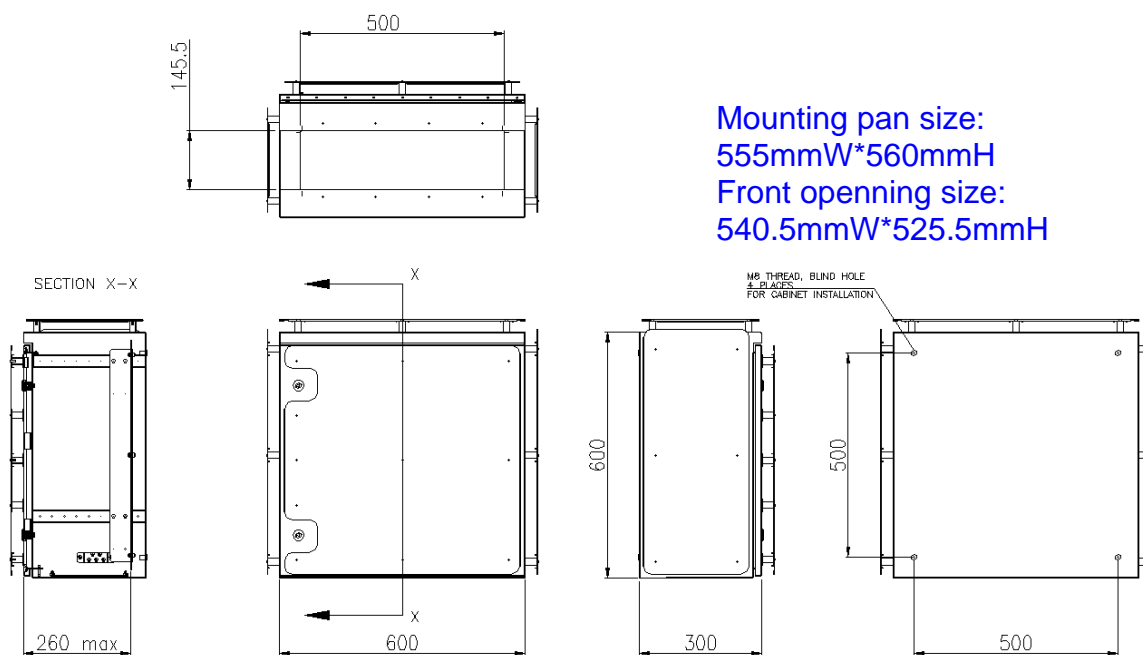

381600000: SGC-CA11

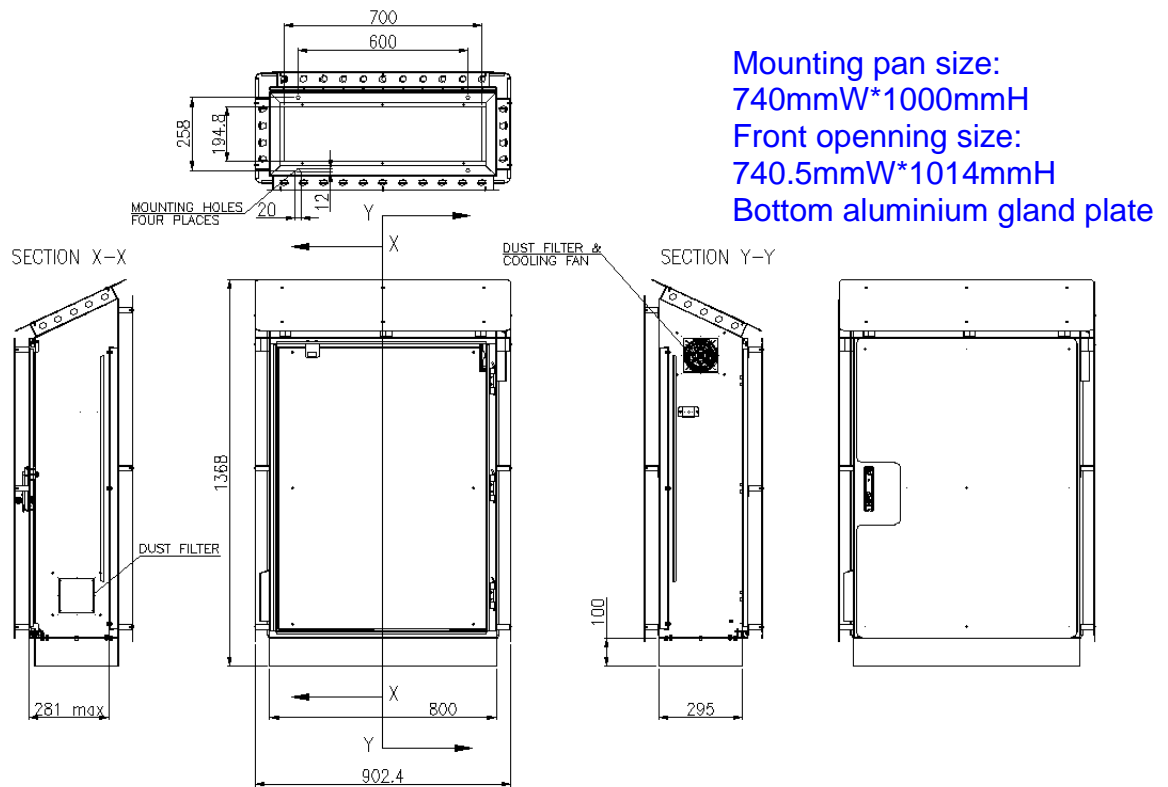

381000000: SGC-CA05

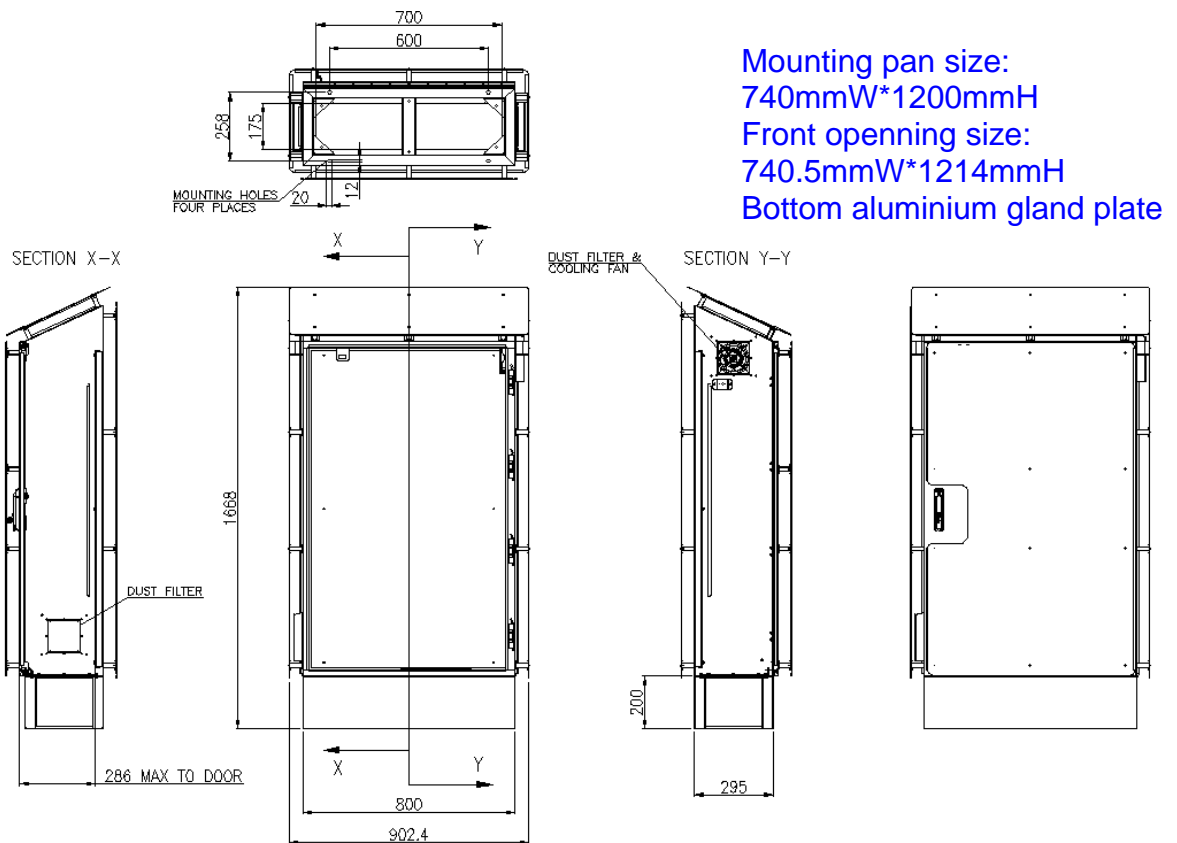

382800000: SGC-8012030

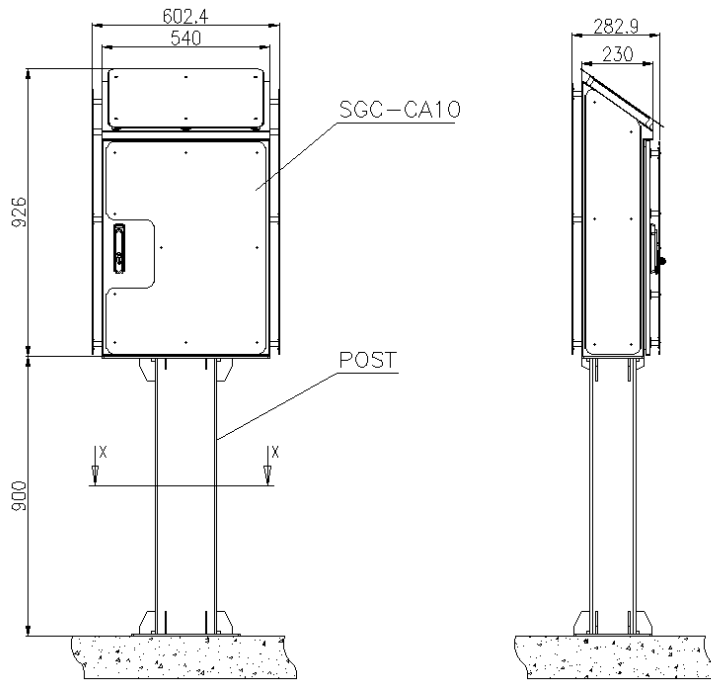

Mounting pan size:
480mmW*686mmH
Front opening size:
480.5mmW*650mmH

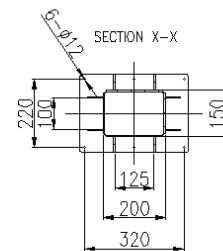

381500000: SGC-CA10

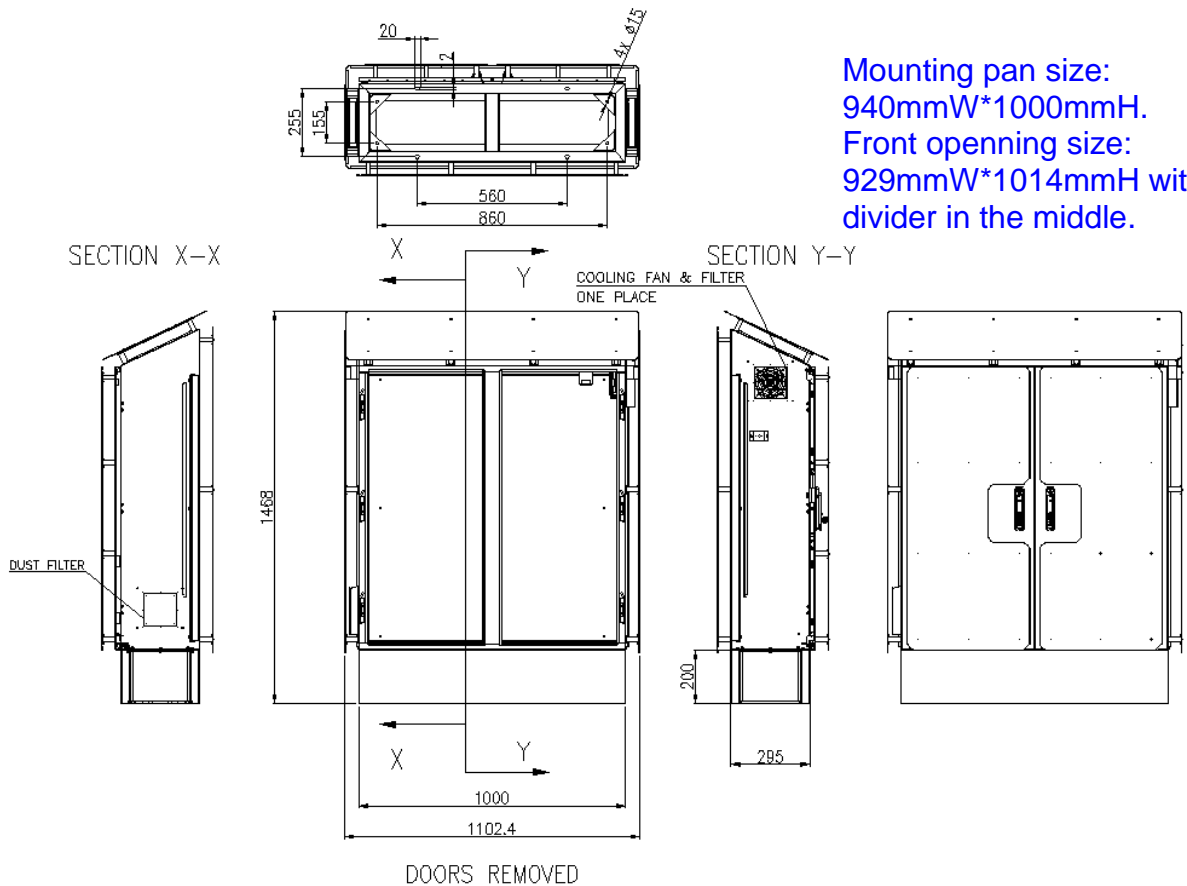

Mounting pan size:
940mmW*1000mmH.
Front opening size:
929mmW*1014mmH with
divider in the middle.

382300000: SGC-10030100T

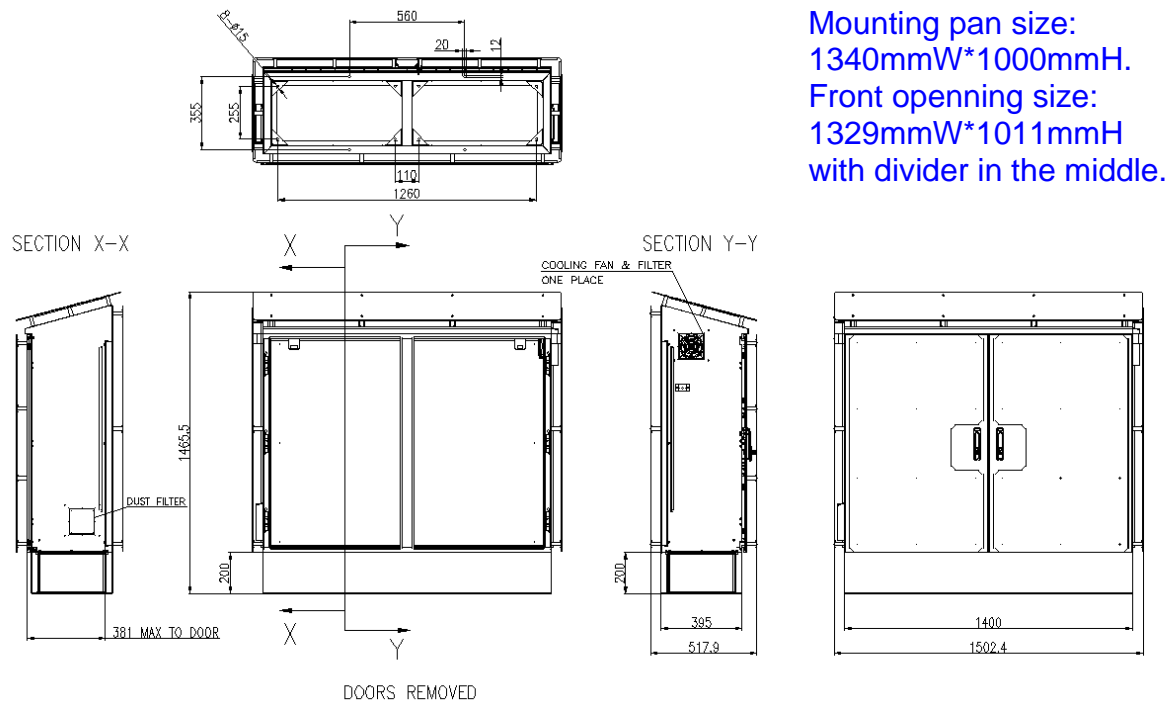

382100000: SGC-10040140

5. 19 inch mounting rails type

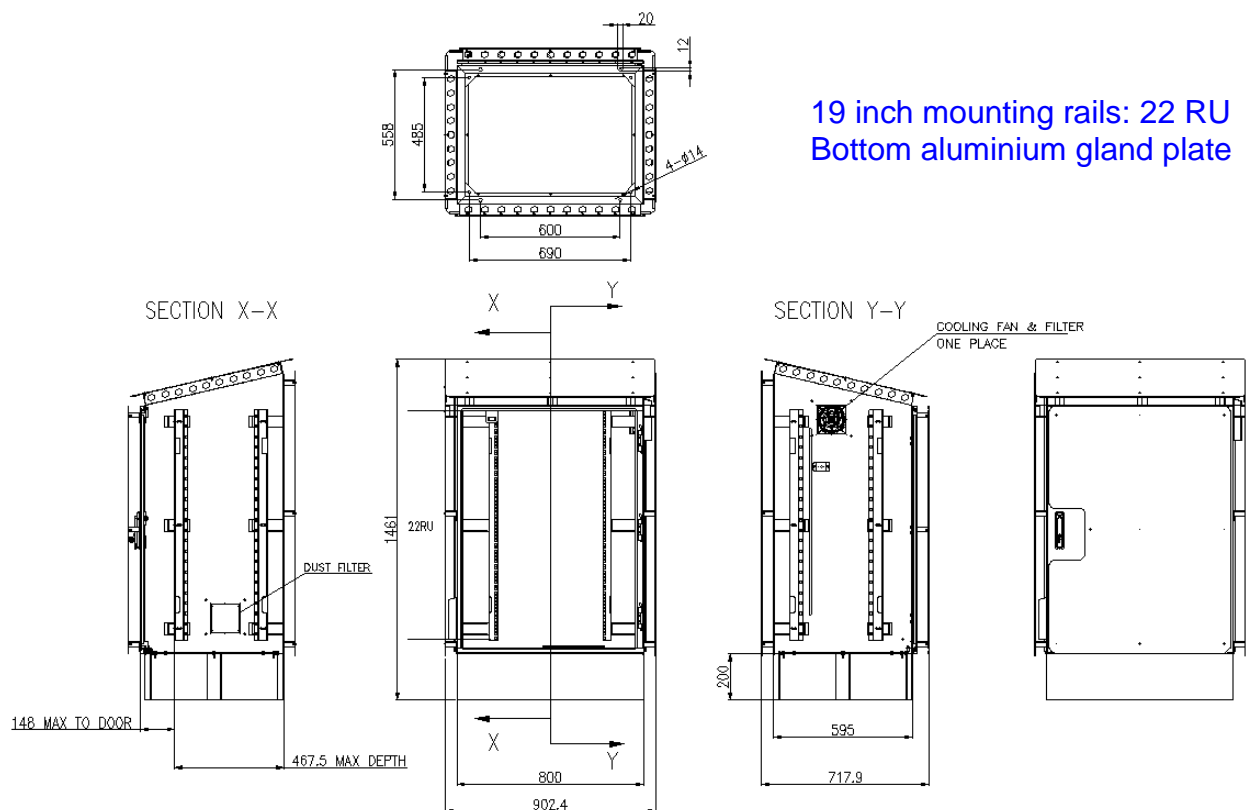

381200000: SGC-8060100T

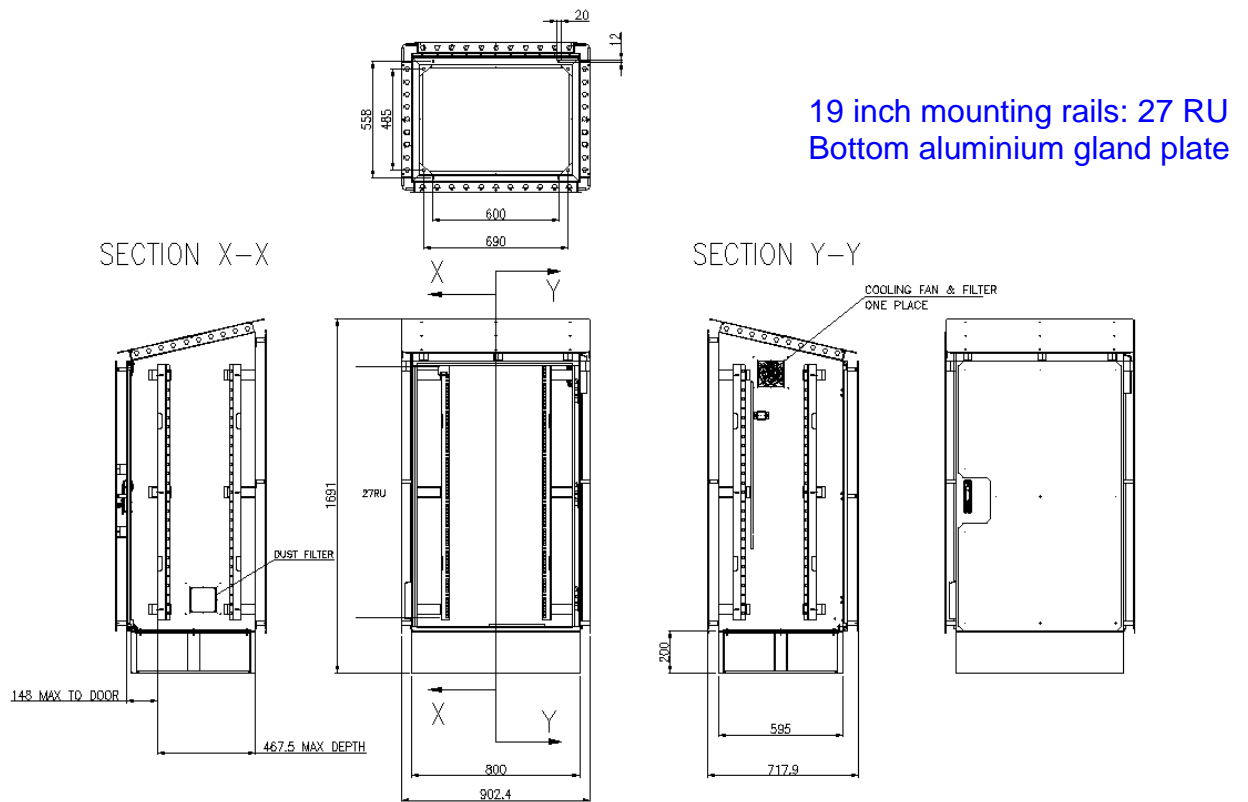

382600000: SGC-806027U

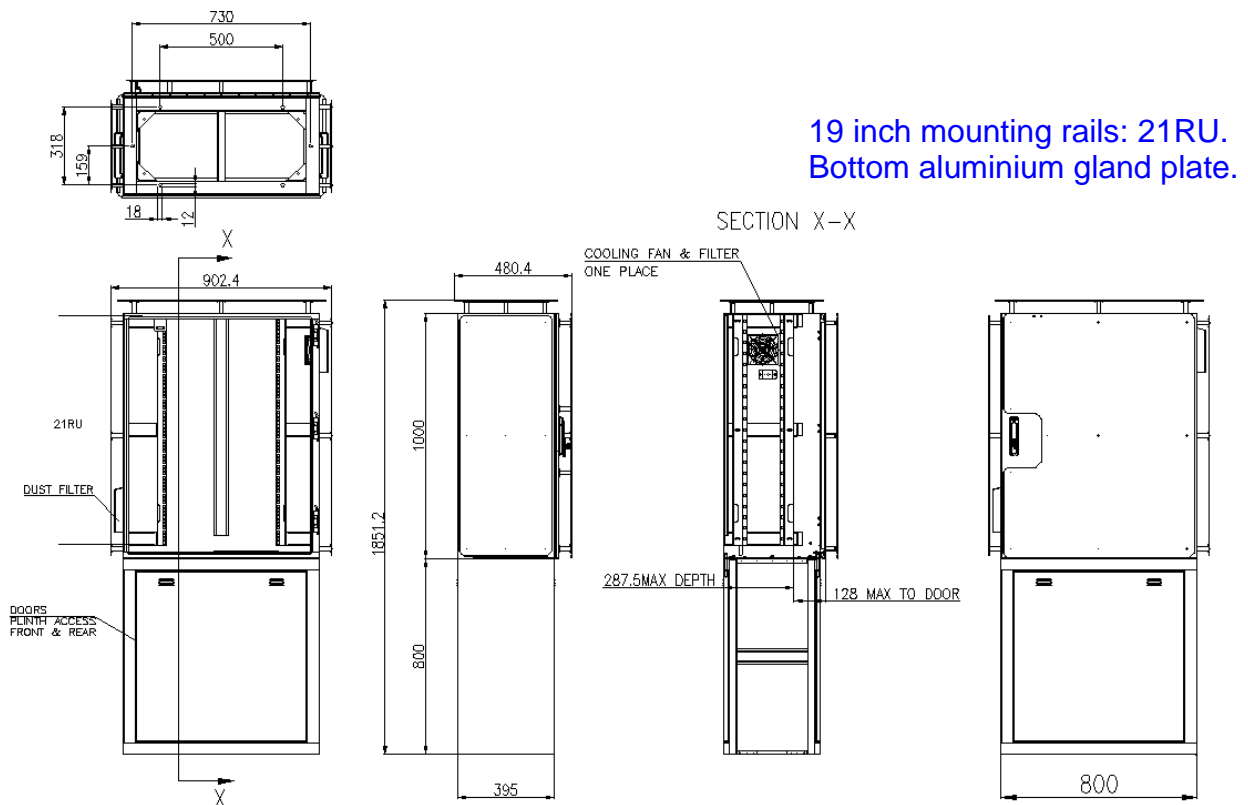

381800000: SGC-8040100T

6. General type

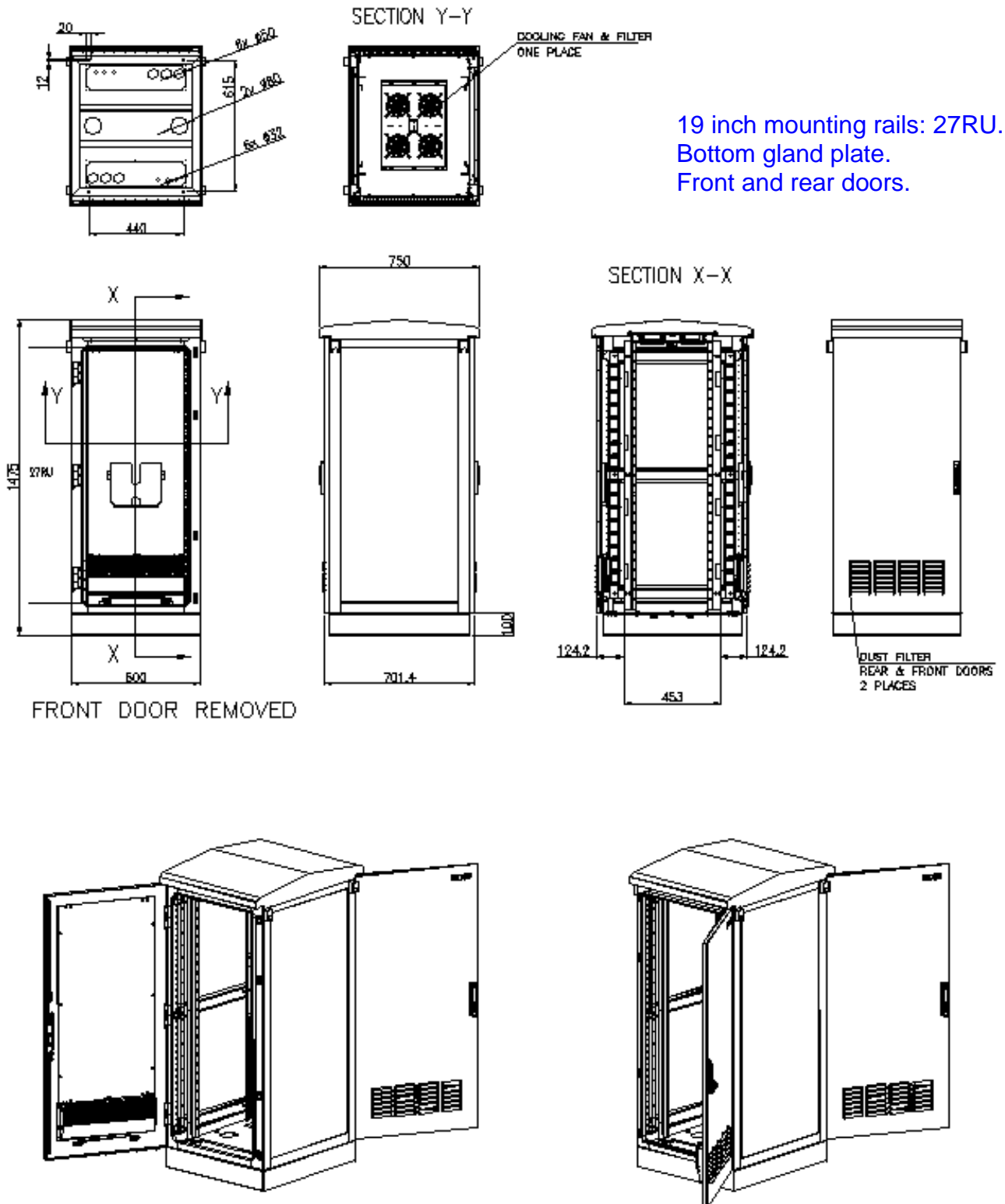

380600000: SGC-27U6070

380800000: SGC-27U6070S

7. Large type

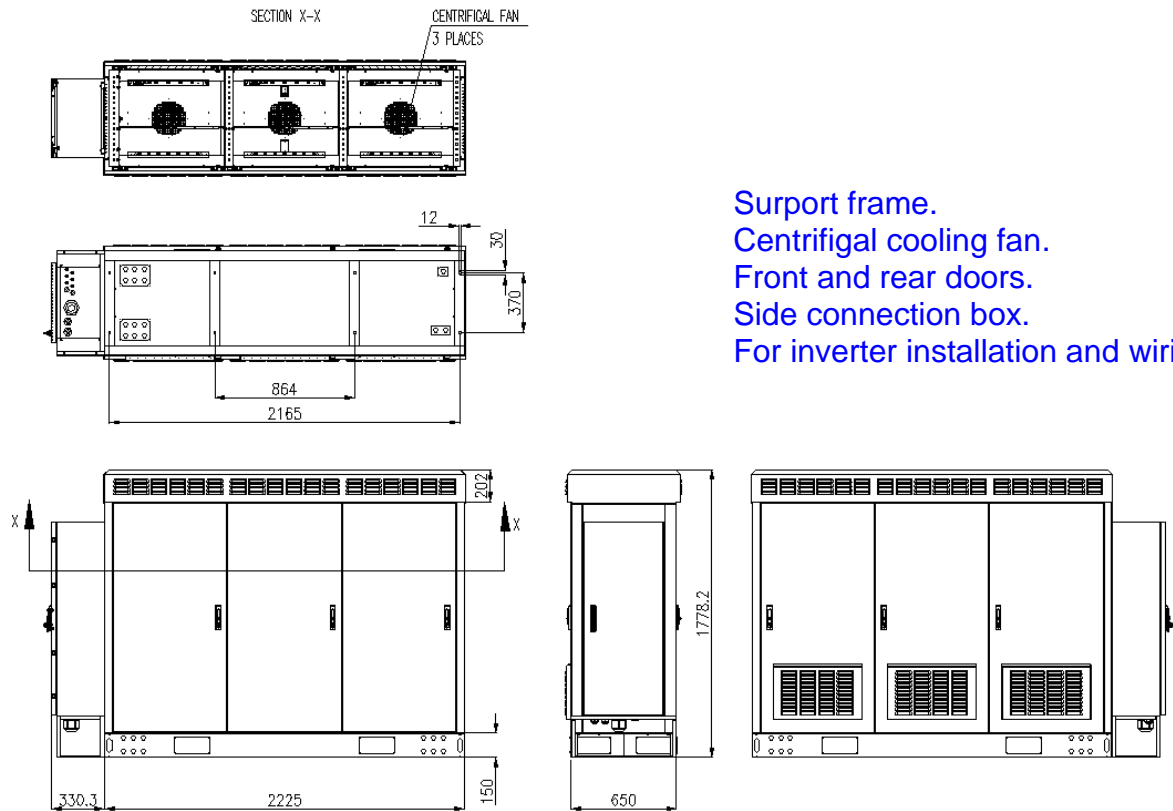

Support frame.
Centrifugal cooling fan.
Front and rear doors.
Side connection box.
For inverter installation and wiring.

379800000: SGC-CA02

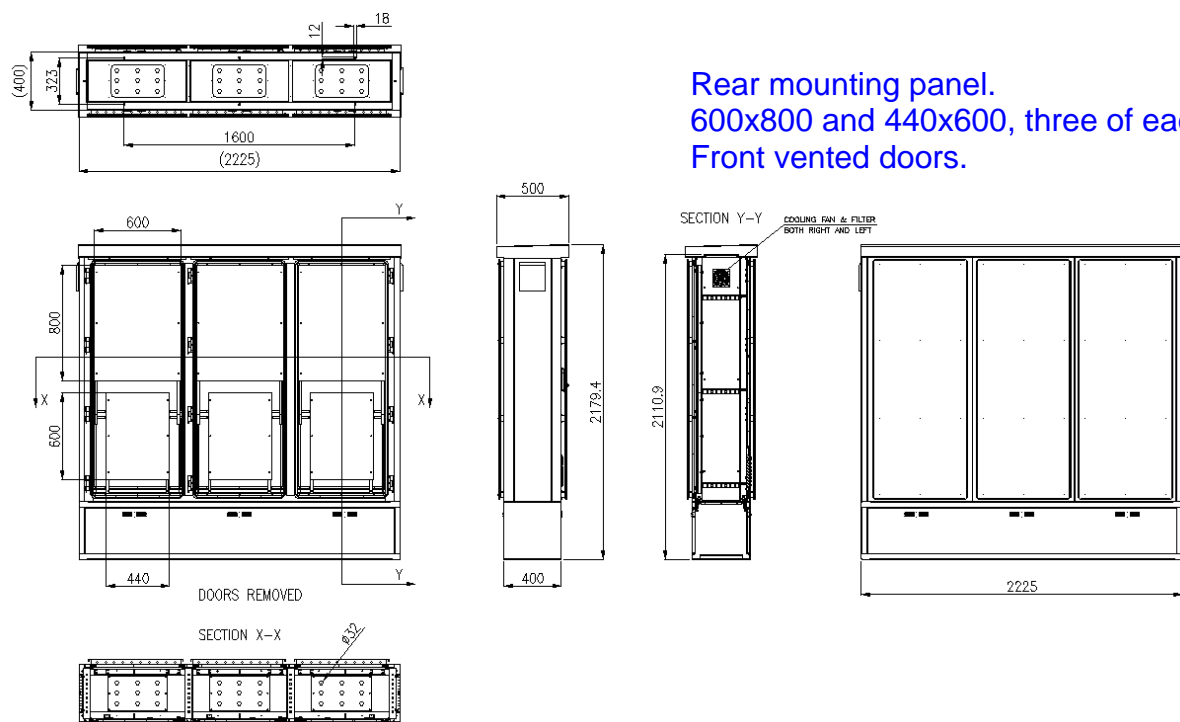

Rear mounting panel.
600x800 and 440x600, three of each.
Front vented doors.



Approved by

Esmond Mo

Issued by

Leo Cui

CATALOGUE OF STAINLESS OUTDOOR CABINET

Document Id

SG-CO-2006-0001

Revision

REV 1

Date

2020-6-4

Page

12 (13)

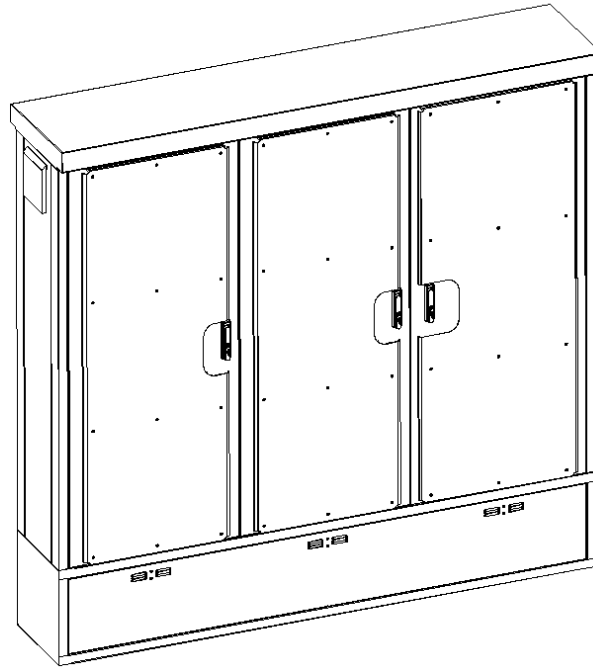

380700000: SGC-CA03



Approved by

Esmond Mo

Issued by

Leo Cui

CATALOGUE OF STAINLESS OUTDOOR CABINET

Document Id

SG-CO-2006-0001

Revision

REV 1

Date

2020-6-4

Page

13 (13)

8. Contact us

Si-GOU Technologies Co., Ltd.

Add: R203, Building B5, Tieta industrial area, Shangcun community, Gongming,
Guangming, Shenzhen, China

Mobile: +86-13798574352

Email: sales@si-gou.com

Web: www.si-gou.com